

IMPRESSION

494



elan

WWW.ELAN-YACHTS.COM

ELAN IMPRESSION 494

OPEN SPACE EXPLORER

"The yacht delivers a consistently pleasurable sailing experience, which means fast cruising and easy handling, even when short-handed. We combined our hull design with an optimal rig and sail area, ensuring the yacht is stable and safe in every sea condition, yet with a very high pointing ability without sacrificing downwind performance. Another strong feature includes the twin wheel - twin rudder system, which ensures better control and handling even in extreme conditions, a self-tacking jib system, a through-deck furling genoa and furling gennaker as an option. All sheets run all the way to the steering position, which allows the helmsman to trim the sails himself, using two winches directly in front of the steering wheels."

Rob Humphreys



- 
- An aerial photograph of a sailboat, likely a Beneteau Impression 494, sailing on a deep blue sea. The boat's deck is finished with light-colored teak planking. A large, white, rectangular canvas cover is positioned on the deck, partially obscuring the cockpit area. The boat's white hull contrasts with the dark water. The mast and rigging are visible on the left side of the frame. A semi-transparent dark grey rectangular box is overlaid on the upper right portion of the image, containing text and a list of features.
- 5+1 CABIN INTERIOR
 - DECK SALOON INVERTED
 - OPEN AFT WITH A LARGE PLATFORM

The Impression 494 embodies what long distance luxury yachts represent.

EXTERIORS

ELAN·IMPRESSION·494

Untangle, unwind and revel in the great outdoors. Discover an unprecedented level of comfort for days of enjoyment in the sun on the largest cockpit in its class, featuring longer U-shaped cockpit seats 2,1 m in length and a foward sun bed. Find a secluded bay and access the immaculate sea easily through the electrically operated swimming platform. And while there, serve yourself a crisp cold drink right from the cockpit fridge and outside bar and revel in the spectacular view and enjoy every detail, designed to live unforgettable moments aboard, when sailing or at anchor.





All sheets are running back to the helmsman's steering position, making sail trimming simple and accessible.



The liferaft can be stored near the helm, on the port side.



The large, electrically operated swimming platform ensures easy access to the sea and uncovers the spacious transom storage.



Cold drinks are always in reach at the cockpit bar, featuring a fridge and optionally even a sink in the outside galley.





Twin rudders ensure better control and handling even in extreme conditions.



INTERIORS

The interior welcomes you with plenty of space and natural light, thanks to the raised deck-saloon layout, numerous hull windows and portlights. Enjoy the open space social area, courtesy of the inverted layout, with the galley forward and the large open plan saloon located directly under the companionway, taking advantage of the yacht's full beam. Celebrate life with friends and family around the spacious saloon with a U-shaped settee and two additional seats. Step down to the roomy, functional galley and navigation station or discover the comfortable, stylish cabins.





Inverted layout provides the largest saloon possible.



Adaptable saloon table transforms into a very comfortable double berth.

Functional U-shaped galley provides more comfort and safety when cooking while sailing or motoring.



Nav station features the media corner and various storage spaces.





Twin fore cabins provide a large double berth, storage and plenty of natural light.



Crew cabin with comfortable bunk berths for additional guests onboard.



TECHNICAL SPECIFICATIONS

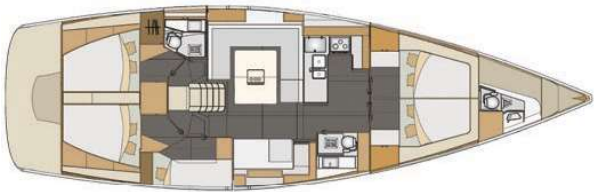

5 cabins + 1 / 3 heads



4 cabins / 3 heads

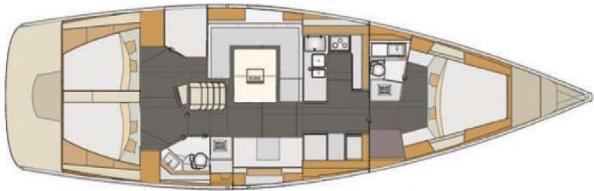

3 cabins / 2 heads



2 cabins / 2 heads

LENGTH OVERALL	14.90 m
HULL LENGTH	14.85 m
LENGTH AT WATERLINE	13.76 m
BEAM MAX	4.68 m
BWL MAX	4.04 m
DRAFT	2.23 m / 1.80 m
DISPLACEMENT	app. 14.500 kg
BALLAST	4.500 kg
ENGINE POWER MAX	55 kW / 75 hp
FUEL CAPACITY	295 liters
WATER CAPACITY	605 liters

MAXIMUM CREW	12 persons
BERTHS	4 + 1 - 12 + 1
MAINSAIL	67,06 m ²
GENOA	49,22 m ²
SPINNAKER	127.00 m ²
I	18.74 m
J	5.25 m
P	17.90 m
E	6.25 m
INTERIOR DESIGN	Gigodesign
DESIGN	Humphreys Yacht Design & Elan design team



POLAR DIAGRAM

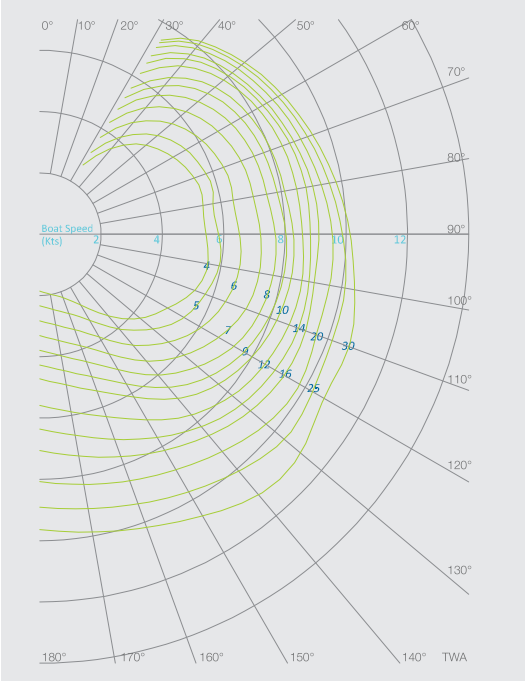

STABILITY CURVE

